

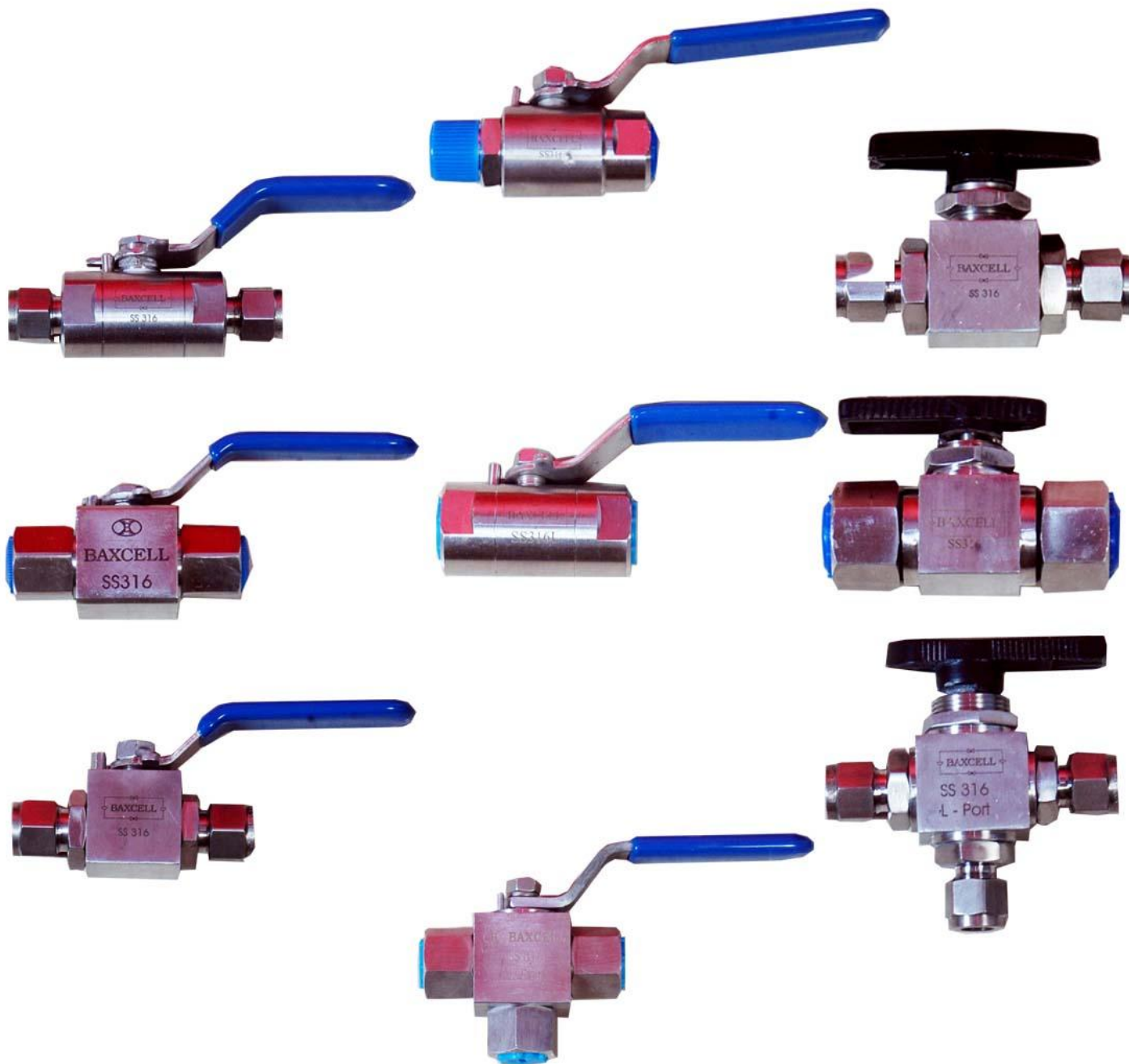

Ball Valves



Ball Valves

Visual Index – [Click on link for desire page.](#)



BAX-BVFF-2W-01
FEMALE – FEMALE
[Page- 5](#)



BAX-BVOD-2W-02
OD x OD
[Page- 6](#)



BAX-BVFF-2W3P-03
FEMALE – FEMALE
[Page- 7](#)



BAX-BVOD-2W3P-04
OD x OD
[Page- 8](#)



BAX-BVFF-3W-05
FEMALE – FEMALE
[Page- 9](#)

Image Not Available

BAX-BVOD-3W-06
OD x OD
[Page- 10](#)



BAX-BVFF-2WP-07
FEMALE – FEMALE
[Page- 11](#)



BAX-BVOD-2WP-08
OD x OD
[Page- 12](#)

Image Not Available

BAX-BVFF-3WP-09
FEMALE – FEMALE
[Page- 13](#)



BAX-BVOD-3WP-10
OD x OD
[Page- 14](#)

Image Not Available

BAX-BVMM-2W-11
MALE x MALE
[Page- 15](#)



BAX-BVMF-2W-12
MALE x FEMALE
[Page- 16](#)

Image Not Available

BAX-BVFM-2W-13
FEMALE x MALE
[Page- 17](#)

Ball Valves

BAXCELL ball valves have very low operating torques and a range of seat materials providing excellent process environmental compatibility. Our seats offer wide process compatibility whilst maintaining a positive sealing across the entire operating range. This high level of seat integrity allows both vacuum and high pressure services from one valve. Recommended for use in Oil, Gas, Petrochemical and general duty applications where reliable long term performance is essential. Stopper for ¼ turn shut-off is standard on all pressure ranges and sizes.

Ball Valves with **locking devices** are available upon request.

BAXCELL Ball Valves are subjected to following pressure tests:

- [a] Hydrostatic test at 1.5 times working pressure.
- [b] Low pressure pneumatic test at 150 PSI (15 bar).
- [c] Shell test to 1.5 times working pressure. [d] Nitrogen or any other testing applicable are available upon request.

- **2 Way Ball Valve**
- **3 Way Ball Valve**
- **4 Way Ball Valve &**
- **5 Way Ball Valve**

Key Features:

- Design : Ball Valve With Bar Type Handle, Panel Mounting Type Handle & 3 / 4 / 5 with On-Off Switching Models .
- Floating Ball Design for Positive Sealing.
- Blow-Out Proof Bottom Loaded Stem. Low Operating Torque and with Panel Mounting Facilities.
- Full Port / Reduced Port Design.
- Working Pressure: 1500 PSI To 6000 PSI .
- Seat: PTFE / RTFE/ DELRIN / PEEK.
- Size : 1/4" To 1".
- End Connections: NPT/ BSP/ BSPT / OD / SW.(Female X Female, Male X Female & Compression Ferrule Tube Fitting Ends.)

Ball Valves

Material :

BAXCELL Ball valves are available in SS 316 & SS 304, Stainless steel Brass, Monel, Hastelloy C, Incoloy 825, Inconel 600 & Titanium. Manifold spares are machined from cold finished bar stock and manifold bodies are machined from close grain forgings. The raw materials used fully conform the chemical requirements of one or more of the specification listed below.

Material	Bar	Forging
Stainless steel	BS 970 316-S 31 DIN 4401 ASME SA 479/276-316	BS 970 316-S 31 DIN 4401 ASME SA 182-316
Brass	B S 2874 C Z 121 ASTM B16 ALLOY 360 IS 319 Grade-I & II	BS 2872 C Z 122 ASTM B124 ALLOY 377 IS 6192
MONEL	BS 3076 NA 13 ASTM B 164	BS 3076 NA 13 ASTM B 164
Hastelloy C276	ASTM B 575	ASTM B 574
Incoloy 825	BS 3076 NA16 ASTM B 425	BS 3076 NA16 ASTM B 425
Inconel 600	ASTM B 166	ASTM B 564

Ball Valves

BAX-BVFF-2W-01

FEMALE - FEMALE

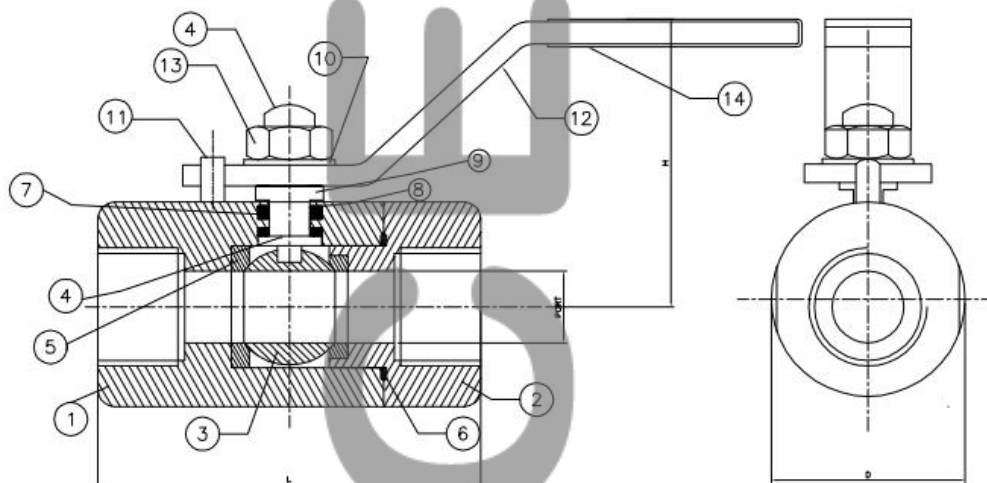
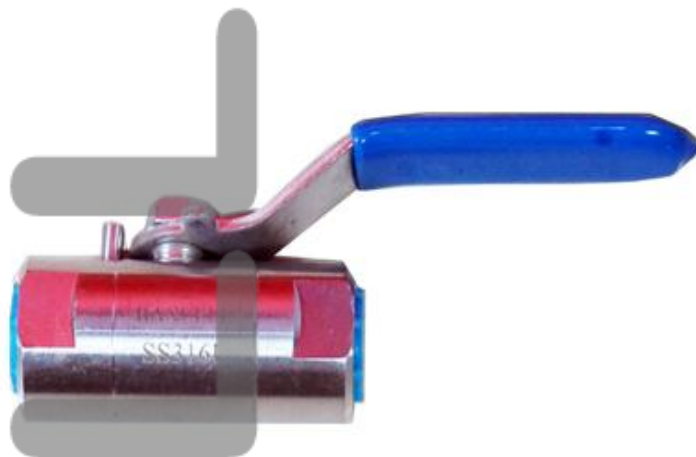

DIMENSIONAL DETAILS

Part No	Inlet	Outlet	L ₁	D ₁	PORT	H	L ₁
BAX-2BVFF-2W	1/8" NPT(F)	1/8" NPT(F)	58.00	25.00	4.50	32.00	95.00
BAX-4BVFF-2W	1/4" NPT(F)	1/4" NPT(F)	58.00	30.00	6.40	40.00	96.00
BAX-6BVFF-2W	3/8" NPT (F)	3/8" NPT (F)	58.00	30.00	9.00	38.00	95.00
BAX-8BVFF-2W	1/2" NPT (F)	1/2" NPT (F)	70.00	35.00	10.40	45.00	110.00
BAX-12BVFF-2W	3/4" NPT(F)	3/4" NPT(F)	80.00	45.00	19.00	54.00	112.00
BAX-16BVFF-2W	1" NPT (F)	1" NPT (F)	84.00	48.00	25.40	60.00	152.00
BAX-20BVFF-2W	1 1/4" NPT (F)	1 1/4" NPT (F)	105.00	65.00	32.00	60.00	155.00
BAX-24BVFF-2W	1 1/2" NPT (F)	1 1/2" NPT (F)	115.00	80.00	38.00	75.00	200.00
BAX-32BVFF-2W	2" NPT(F)	2" NPT(F)	125.00	102.00	50.00	85.00	200.00

Sr. No	Description	Material of Construction			Qty
1	Body	SS 316	SS 304	CS A 105	1
2	Adapter	SS 316	SS 304	CS A 105	1
3	Ball	SS 316	SS 304	SS 304	1
4	Spindle	SS 316	SS 304	SS 304	1
5	Ball Seat	P.T.F.E	P.T.F.E	P.T.F.E	2
6	Joint Seal	P.T.F.E	P.T.F.E	P.T.F.E	1
7	Stem Seal	P.T.F.E	P.T.F.E	P.T.F.E	1
8	Stem Washer	SS 316	SS 304	SS 304	1
9	Upper Gland	SS 316	SS 316	SS 316	1
10	Spring Washer	SS	SS	SS	1
11	Stoper Pin	SS 304	SS 304	SS 304	1
12	Handle	CS PLATED	CS PLATED	CS PLATED	1
13	Nut	SS	SS	SS	1
14	Sleeve	P.V.C	P.V.C	P.V.C	1

BAX-BVOD-2W-02

OD x OD

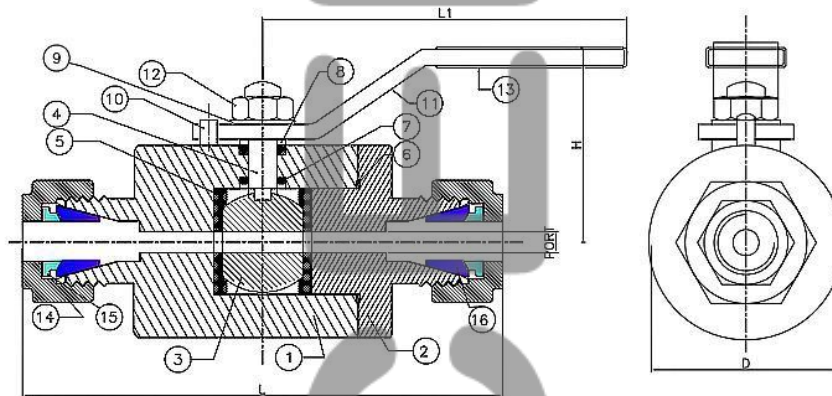

DIMENSIONAL DETAILS

Part No	Inlet	Outlet	L ± 1	D ± 2	PORT	H	L1
BAX-2BVOD-2W	1/8" OD	1/8" OD	58.00	25.00	4.50	32.00	95.00
BAX-4BVOD-2W	1/4" OD	1/4" OD	78.00	30.00	4.80	40.00	96.00
BAX-6BVOD-2W	3/8" OD	3/8" OD	58.00	30.00	9.00	38.00	95.00
BAX-8BVOD-2W	1/2" OD	1/2" OD	88.00	35.00	10.40	45.00	110.00
BAX-12BVOD-2W	3/4" OD	3/4" OD	106.00	45.00	15.00	50.00	110.00
BAX-16BVOD-2W	1" OD	1" OD	84.00	53.00	25.00	60.00	150.00

Sr. No	Description	Material of Construction			Qty
1	Body	SS 316	SS 304	CS A 105	1
2	Adapter	SS 316	SS 304	CS A 105	1
3	Ball	SS 316	SS 304	SS 304	1
4	Spindle	SS 316	SS 304	SS 304	1
5	Ball Seat	P.T.F.E	P.T.F.E	P.T.F.E	2
6	Joint Seal	VITON	VITON	VITON	1
7	Gland Seal	P.T.F.E	P.T.F.E	P.T.F.E	1
8	Gland	SS 316	SS 304	SS 304	1
9	Spring Washer	SS	SS	SS	1
10	Stoper Pin	SS 304	SS 304	SS 304	1
11	Handle	CS PLATED	CS PLATED	CS PLATED	1
12	Nut	SS	SS	SS	1
13	Sleeve	P.V.C	P.V.C	P.V.C	1
14	Nut	SS 316	SS 304	SS 304	2
15	Front Ferrule	SS 316	SS 304	SS 304	2
16	Back Ferrule	SS 316	SS 304	SS 304	2

Ball Valves

BAX-BVFF-2W3P-03

FEMALE - FEMALE

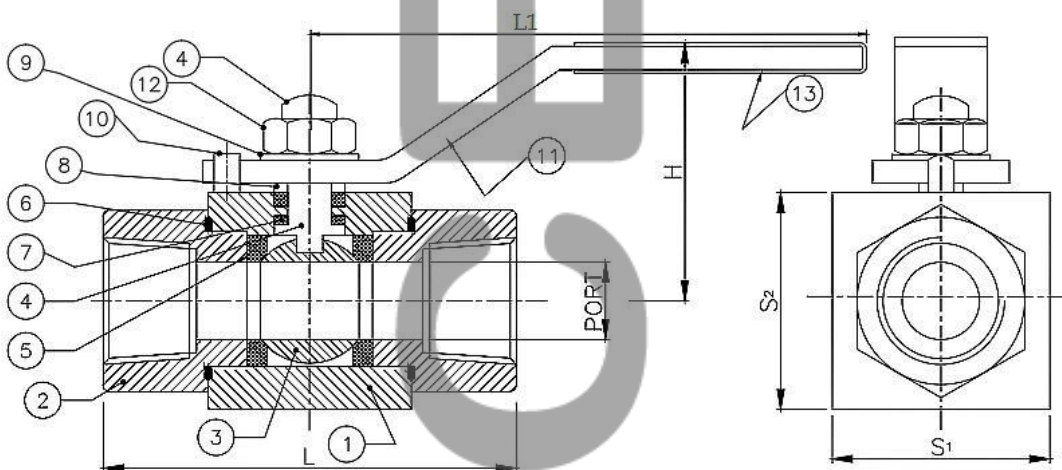

DIMENSIONAL DETAILS

Part No.	Inlet	Outlet	L +/-2	S ₁	S ₂	PORT	H	L1
BAX-2BVFF-2W3P	⅝" NPT(F)	⅝" NPT(F)	55.00	25.00	28.00	4.50	37.00	95.00
BAX-4BVFF-2W3P	¾" NPT(F)	¾" NPT(F)	60.00	25.00	32.00	7.00	38.00	95.00
BAX-6BVFF-2W3P	⅞" NPT(F)	⅞" NPT(F)	60.00	28.00	32.00	7.00	38.00	95.00
BAX-8BVFF-2W3P	1" NPT(F)	1" NPT(F)	90.00	32.00	38.00	11.50	52.00	130.00
BAX-12BVFF-2W3P	1½" NPT(F)	1½" NPT(F)	80.00	44.00	45.00	19.00	55.00	130.00
BAX-16BVFF-2W3P	2" NPT(F)	2" NPT(F)	87.00	55.00	60.00	19.00	63.00	150.00
BAX-20BVFF-2W3P	2½" NPT(F)	2½" NPT(F)	105.00	62.00	70.00	32.00	68.00	200.00
BAX-24BVFF-2W3P	3" NPT(F)	3" NPT(F)	115.00	75.00	80.00	38.00	73.00	200.00
BAX-32BVFF-2W3P	4" NPT(F)	4" NPT(F)	125.00	100.00	105.00	50.00	85.00	200.00

Sr. No	Description	Material of Construction			Qty
1	Body	SS 316	SS 304	CS A 105	1
2	Adapter	SS 316	SS 304	CS A 105	1
3	Ball	SS 316	SS 304	SS 304	1
4	Spindle	SS 316	SS 304	SS 304	1
5	Ball Seat	P.T.F.E / DELRIN	P.T.F.E / DELRIN	P.T.F.E / DELRIN	2
6	Joint Seal	VITON	VITON	VITON	1
7	Gland Seal	P.T.F.E	P.T.F.E	P.T.F.E	1
8	Gland	SS 316	SS 304	SS 304	1
9	Spring Washer	SS	SS	SS	1
10	Stoper Pin	SS 304	SS 304	SS 304	1
11	Handle	CS PLATED	CS PLATED	CS PLATED	1
12	Nut	SS	SS	SS	1
13	Sleeve	P.V.C	P.V.C	P.V.C	1

BAX-BVOD-2W3P-04

OD x OD

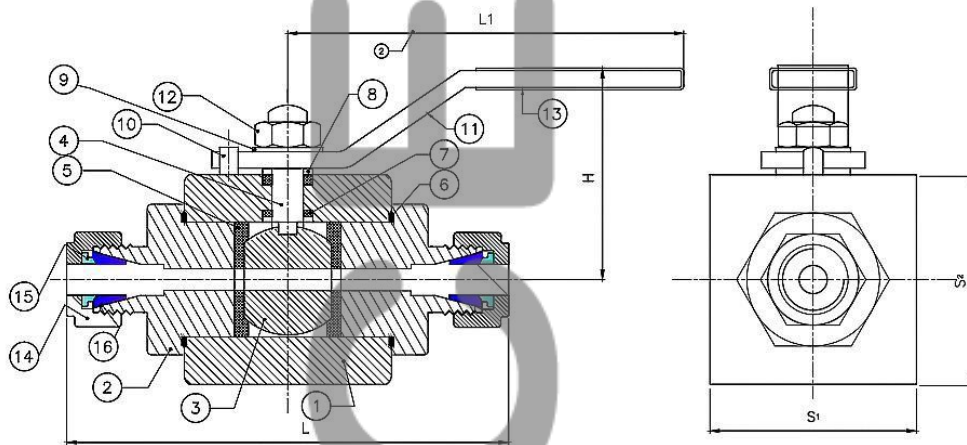

DIMENSIONAL DETAILS

Part No.	Inlet	Outlet	L	S ₁	S ₂	PORT	H	L1
BAX-2BVOD-2W3P	½" OD	½" OD	79.00	25.00	30.00	2.50	40.00	95.00
BAX-4BVOD-2W3P	¾" OD	¾" OD	79.00	25.00	30.00	4.80	40.00	95.00
BAX-6BVOD-2W3P	¾" OD	¾" OD	85.00	28.00	30.00	7.10	40.00	95.00
BAX-8BVOD-2W3P	1" OD	1" OD	94.00	32.00	38.00	10.40	48.00	130.00
BAX-12BVOD-2W3P	1½" OD	1½" OD	110.00	44.00	45.00	15.00	48.00	130.00
BAX-16BVOD-2W3P	2" OD	2" OD	118.00	50.00	55.00	22.20	52.00	150.00

Sr. No	Description	Material of Construction			Qty
		SS 316	SS 304	CS A 105	
1	Body	SS 316	SS 304	CS A 105	1
2	Adapter	SS 316	SS 304	CS A 105	2
3	Ball	SS 316	SS 304	SS 304	1
4	Spindle	SS 316	SS 304	SS 304	1
5	Ball Seat	P.T.F.E / DELRIN	P.T.F.E / DELRIN	P.T.F.E / DELRIN	2
6	Joint Seal	VITON	VITON	VITON	1
7	Gland Seal	P.T.F.E	P.T.F.E	P.T.F.E	1
8	Gland	SS 316	SS 304	SS 304	1
9	Washer	CS PLATED	CS PLATED	CS PLATED	1
10	Stoper Pin	SS 304	SS 304	SS 304	1
11	Handle	CS PLATED	CS PLATED	CS PLATED	1
12	Nut	CS PLATED	CS PLATED	CS PLATED	1
13	Sleeve	P.V.C	P.V.C	P.V.C	1
14	Nut	SS 316	SS 304	SS 304	2
15	Front Ferrule	SS 316	SS 304	SS 304	2
16	Back Ferrule	SS 316	SS 304	SS 304	2

BAX-BVFF-3W-05

FEMALE - FEMALE

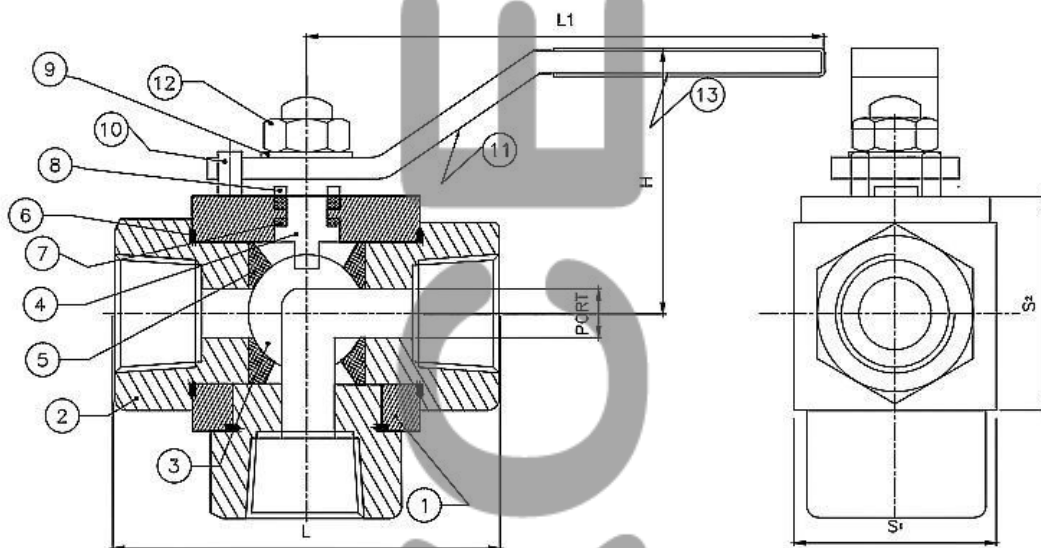
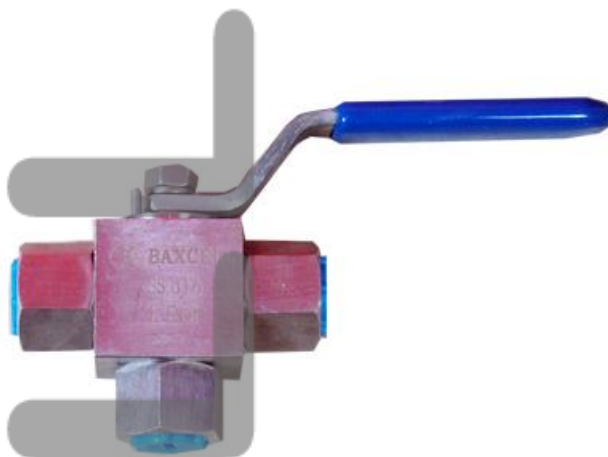

DIMENSIONAL DETAILS

PART No.	Inlet	Outlet	L	S ₁	S ₂	PORT	H	L1
BAX-2BVFF-3W	1/8" NPT(F)	1/8" NPT(F)	70.00	30.00	38.00	4.50	41.00	95.00
BAX-4BVFF-3W	1/4" NPT(F)	1/4" NPT(F)	70.00	30.00	38.00	7.00	41.00	95.00
BAX-6BVFF-3W	3/8" NPT(F)	3/8" NPT(F)	72.00	30.00	38.00	7.00	41.00	95.00
BAX-8BVFF-3W	1/2" NPT(F)	1/2" NPT(F)	90.00	36.00	43.50	12.00	57.00	132.00
BAX-12BVFF-3W	3/4" NPT(F)	3/4" NPT(F)	94.00	45.00	54.00	19.00	62.00	132.00
BAX-16BVFF-3W	1" NPT(F)	1" NPT(F)	96.00	52.00	60.00	22.20	65.00	150.00

Sr. No	Description	Material of Construction			Qty
1	Body	SS 316	SS 304	CS A 105	1
2	Adapter	SS 316	SS 304	CS A 105	1
3	Ball	SS 316	SS 304	CS A 105	1
4	Stem	SS 316	SS 304	CS A 105	1
5	Ball Seat	P.T.F.E / DELRIN	P.T.F.E / DELRIN	P.T.F.E / DELRIN	2
6	Joint Seal	VITON	VITON	VITON	1
7	Gland Seal	P.T.F.E	P.T.F.E	P.T.F.E	1
8	Gland Retainer	SS 316	SS 304	SS 304	1
9	Washer	CS PLATED	CS PLATED	CS PLATED	1
10	Stop Pin	SS 304	SS 304	SS 304	1
11	Handle	CS PLATED	CS PLATED	CS PLATED	1
12	Nut	CS PLATED	CS PLATED	CS PLATED	1
13	Sleeve	P.V.C	P.V.C	P.V.C	1

BAX-BVOD-3W-06

OD x OD

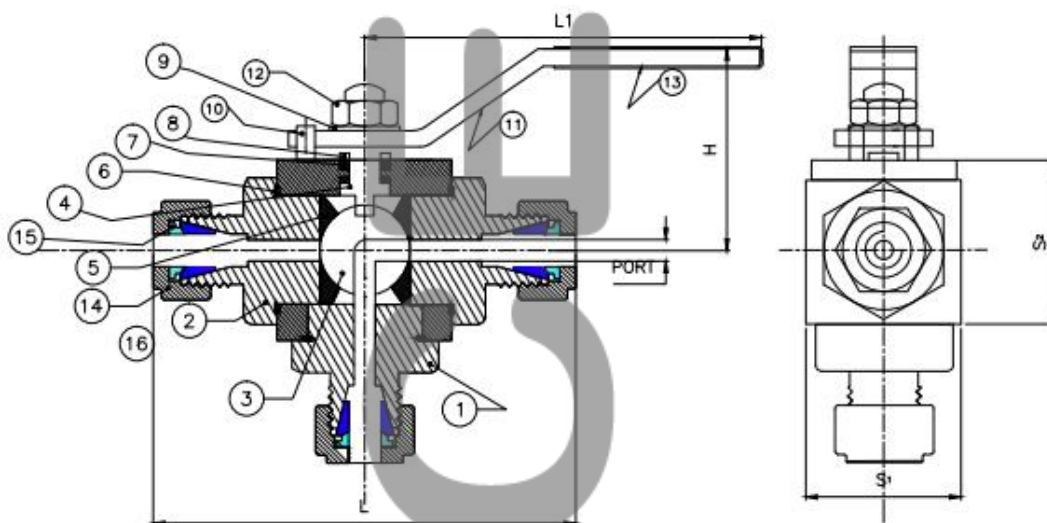

DIMENSIONAL DETAILS

Part No	Inlet	Outlet	L	S ₁	S ₂	Port	H	L ₁
BAX-2BVOD-3W	1/4" OD	1/4" OD	82.00	30.00	38.00	2.50	41.00	95.00
BAX-4BVOD-3W	1/4" OD	1/4" OD	82.00	30.00	38.00	4.80	41.00	95.00
BAX-6BVOD-3W	3/8" OD	3/8" OD	87.00	30.00	38.00	7.10	41.00	95.00
BAX-8BVOD-3W	1/2" OD	1/2" OD	100.00	36.00	43.50	10.40	57.00	132.00
BAX-12BVOD-3W	3/4" OD	3/4" OD	112.00	45.00	54.00	15.00	62.00	132.00
BAX-16BVOD-3W	1" OD	1" OD	118.00	52.00	60.00	22.20	65.00	150.00

Sr. No	Description	Material of Construction			Qty
1	Body	SS 316	SS 304	CS A 105	1
2	Adapter	SS 316	SS 304	CS A 105	1
3	Ball	SS 316	SS 304	CS A 105	1
4	Stem	SS 316	SS 304	CS A 105	1
5	Ball Seat	P.T.F.E / DELRIN	P.T.F.E / DELRIN	P.T.F.E / DELRIN	2
6	Joint Seal	VITON	VITON	VITON	1
7	Gland Seal	P.T.F.E	P.T.F.E	P.T.F.E	1
8	Gland Retainer	SS 316	SS 304	SS 304	1
9	Washer	CS PLATED	CS PLATED	CS PLATED	1
10	Stop Pin	SS 304	SS 304	SS 304	1
11	Handle	CS PLATED	CS PLATED	CS PLATED	1
12	Nut	CS PLATED	CS PLATED	CS PLATED	1
13	Sleeve	P.V.C	P.V.C	P.V.C	1
14	Nut	SS 316	SS 304	SS 304	2
15	Front Ferrule	SS 316	SS 304	SS 304	2
16	Back Ferrule	SS 316	SS 304	SS 304	2

Ball Valves

BAX-BVFF-2WP-07

FEMALE - FEMALE

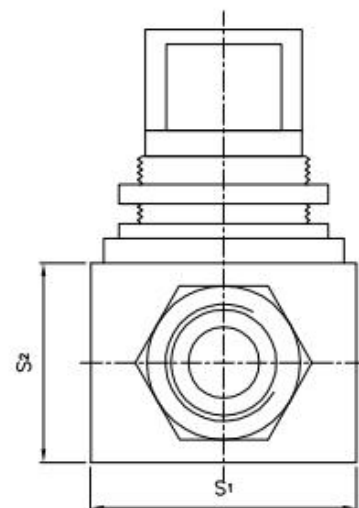
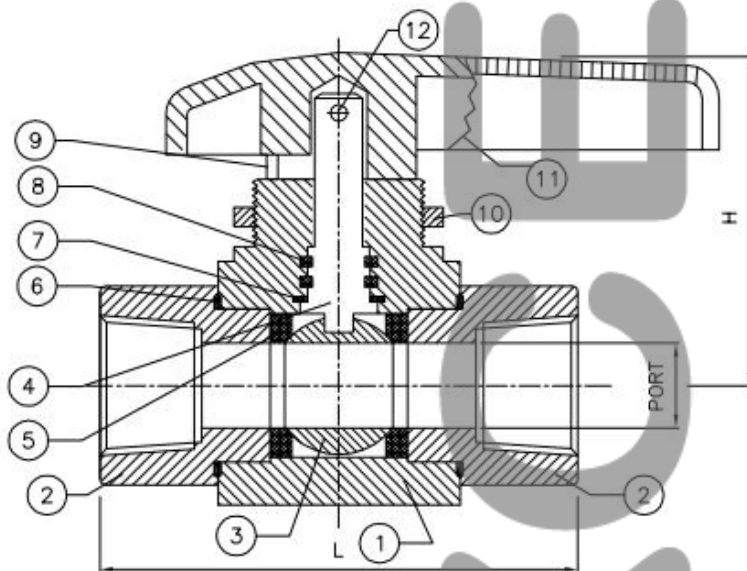
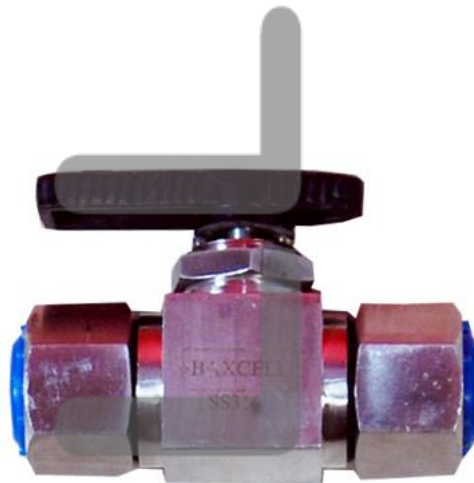

DIMENSIONAL DETAILS

Part No.	Inlet	Outlet	L	S1	S2	PORT	H
BAX-4BVFF-2WP	1/4" NPT(F)	1/4" NPT(F)	66.00	25.00	30.00	7.00	45.00
BAX-6BVFF-2WP	3/8" NPT(F)	3/8" NPT(F)	66.00	25.00	30.00	7.00	45.00
BAX-8BVFF-2WP	1/2" NPT(F)	1/2" NPT(F)	90.00	32.00	38.00	12.00	50.00

Sr. No	Description	Material of Construction			Qty
1	Body	SS 316	SS 304	CS A 105	1
2	Adapter	SS 316	SS 304	CS A 105	1
3	Ball	SS 316	SS 304	CS A 105	1
4	Stem / Spindle	PTFE / SS 316 / DELRIN	SS 304	CS A 105	1
5	Ball Seat	DELIN	DELIN	DELIN	2
6	Joint Seal	VITON	VITON	VITON	1
7	Gland Seal	P.T.F.E	P.T.F.E	P.T.F.E	1
8	Gland Retainer/Spindle O' Ring	SS 316	SS 304	SS 304	1
9	Stop Pin	SS 304	SS 304	SS 304	1
10	Check nut	CS PLATED	CS PLATED	CS PLATED	1
11	Handle	PLASTIC KNOB WITH BRASS INTERNALS.			1
12	Screw	CS PLATED	CS PLATED	CS PLATED	1

BAX-BVOD-2WP-08

OD x OD

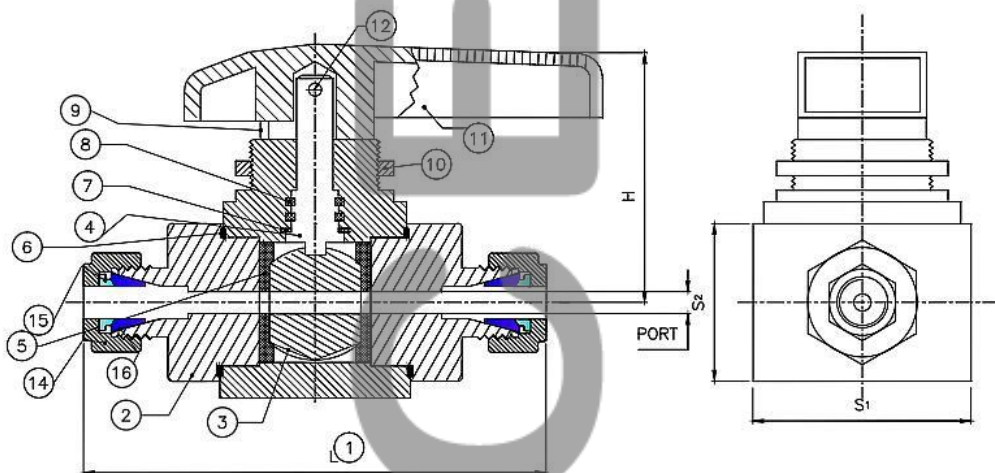

DIMENSIONAL DETAILS

Part No.	Inlet	Outlet	L	S1	S2	PORT	H
BAX-4BVOD-2WP	¼" OD	¼" OD	82.00	25.00	30.00	4.80	45.00
BAX-8BVOD-2WP	½" OD	½" OD	92.00	32.00	38.00	10.40	50.00

Sr. No	Description	Material of Construction			Qty
1	Body	SS 316	SS 304	CS A 105	1
2	Adapter	SS 316	SS 304	CS A 105	1
3	Ball	SS 316	SS 304	CS A 105	1
4	Stem / Spindle	SS 316	SS 304	CS A 105	1
5	Ball Seat	DELTRIN	DELTRIN	DELTRIN	2
6	Joint Seal	VITON	VITON	VITON	1
7	Gland Seal	P.T.F.E	P.T.F.E	P.T.F.E	1
8	Gland Retainer/ Spindle 'O' Ring	SS 316	SS 304	SS 304	1
9	Stop Pin	SS 304	SS 304	SS 304	1
10	Check nut	CS PLATED	CS PLATED	CS PLATED	1
11	Handle	CS PLATED	CS PLATED	CS PLATED	1
12	Screw	CS PLATED	CS PLATED	CS PLATED	1
13	Nut	SS 316	SS 304	SS 304	2
14	Front Ferrule	SS 316	SS 304	SS 304	2
15	Back Ferrule	SS 316	SS 304	SS 304	2

BAX-BVFF-3WP-09

FEMALE - FEMALE

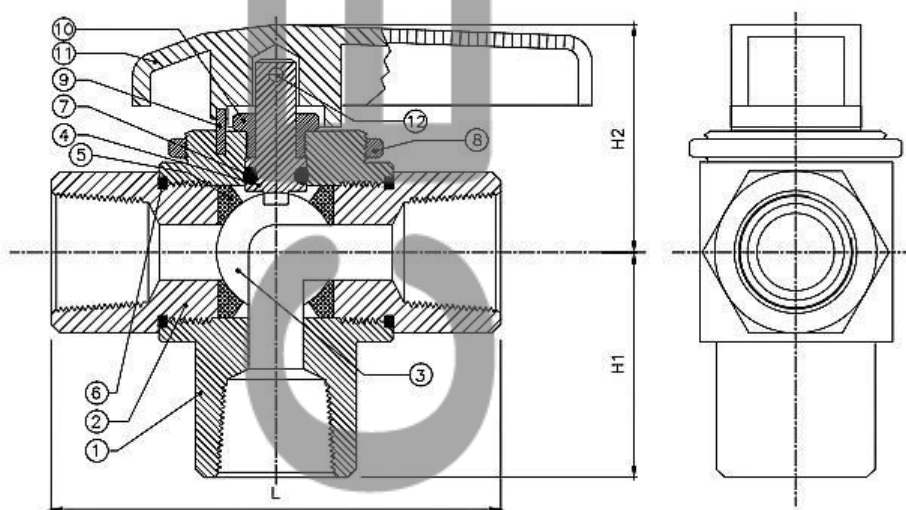

DIMENSIONAL DETAILS

Part No	Size NPT/BSP	L	H1	H2
BAX-4BV3PFFF	1/4"	82.00	36.00	50.00
BAX-6BV3PFFF	3/8"	86.00	38.00	50.00
BAX-8BV3PFFF	1/2"	92.00	44.00	50.00
BAX-12BV3PFFF	3/4"	98.00	48.00	58.00
BAX-16BV3PFFF	1"	110.00	52.00	60.00

Sr. No	Description	Material of Construction			Qty
1	Body	SS 316	SS 304	CS A 105	1
2	Adapter	SS 316	SS 304	CS A 105	1
3	Ball	SS 316	SS 304	CS A 105	1
4	Stem / Spindle	SS 316	SS 304	CS A 105	1
5	Ball Seat	P.T.F.E / DELRIN	P.T.F.E / DELRIN	P.T.F.E / DELRIN	2
6	Joint Seal	VITON	VITON	VITON	1
7	Gland Seal	P.T.F.E	P.T.F.E	P.T.F.E	1
8	Gland Retainer/ Spindle 'O' Ring	SS 316	SS 304	SS 304	1
9	Stop Pin	SS 304	SS 304	SS 304	1
10	Check nut	CS PLATED	CS PLATED	CS PLATED	1
11	Handle	PLASTIC KNOB WITH BRASS INTERNALS.			1
12	Screw	CS PLATED	CS PLATED	CS PLATED	1

BAX-BVOD-3WP-10

OD x OD

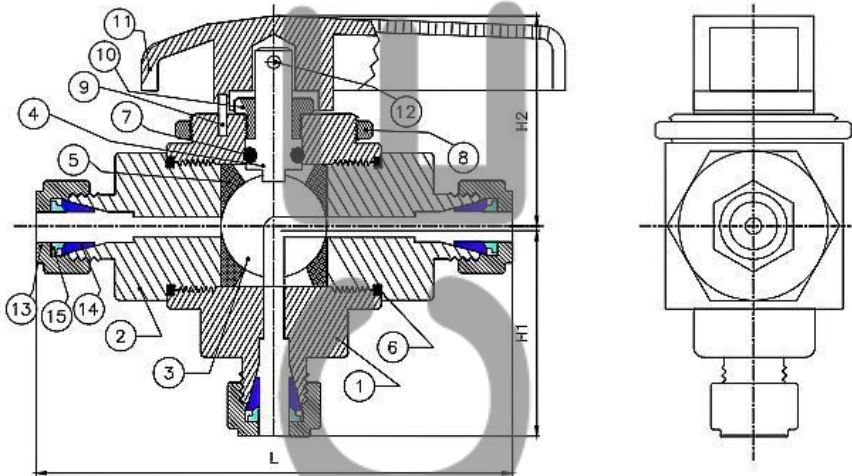
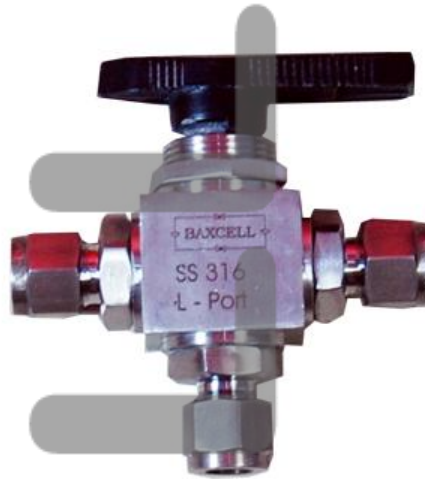

DIMENSIONAL DETAILS

Part No	Size	L	H1	H2
BAX-4BVOD3W	1/4"	82.00	36.00	50.00
BAX-6BVOD3W	3/8"	86.00	38.00	50.00
BAX-8BVOD3W	1/2"	100.00	44.00	50.00
BAX-12BVOD3W	3/4"	112.00	48.00	58.00
BAX-16BVOD3W	1"	118.00	52.00	60.00

Sr. No	Description	Material of Construction			Qty
1	Body	SS 316	SS 304	CS A 105	1
2	Adapter	SS 316	SS 304	CS A 105	1
3	Ball	SS 316	SS 304	CS A 105	1
4	Stem / Spindle	SS 316	SS 304	CS A 105	1
5	Ball Seat	P.T.F.E / DELRIN	P.T.F.E / DELRIN	P.T.F.E / DELRIN	2
6	Joint Seal	VITON	VITON	VITON	1
7	Gland Seal	P.T.F.E	P.T.F.E	P.T.F.E	1
8	Gland Retainer/ Spindle 'O' Ring	SS 316	SS 304	SS 304	1
9	Stop Pin	SS 304	SS 304	SS 304	1
10	Check nut	CS PLATED	CS PLATED	CS PLATED	1
11	Handle	PLASTIC KNOB WITH BRASS INTERNALS.			1
12	Screw	CS PLATED	CS PLATED	CS PLATED	1
13	Nut	SS 316	SS 304	SS 304	2
14	Front Ferrule	SS 316	SS 304	SS 304	2
15	Back Ferrule	SS 316	SS 304	SS 304	2

BAX-BVMM-2W-11

MALE x MALE

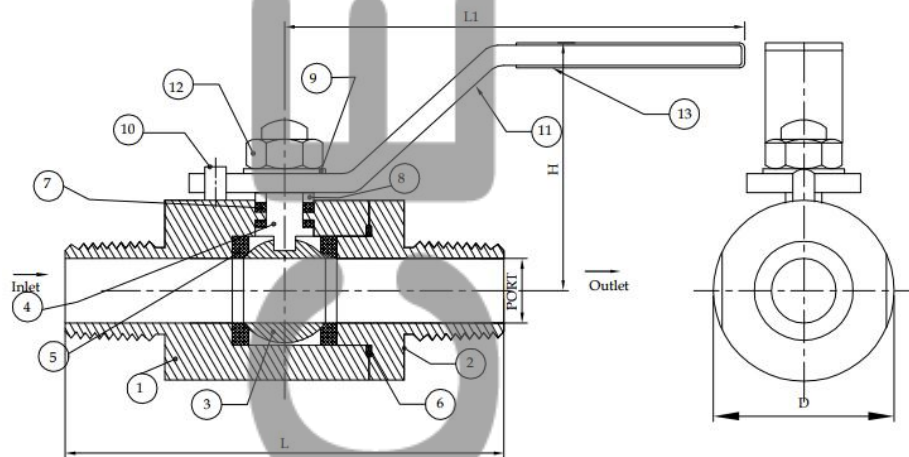

DIMENSIONAL DETAILS

Sr. No	Description	Material of Construction			Qty
1	Body	SS 316	SS 304	CS A 105	1
2	Adapter	SS 316	SS 304	CS A 105	1
3	Ball	SS 316	SS 304	SS 304	1
4	Spindle	SS 316	SS 304	SS 304	1
5	Ball Seat	P.T.F.E	P.T.F.E	P.T.F.E	2
6	Joint Seal	P.T.F.E	P.T.F.E	P.T.F.E	1
7	Gland Seal	P.T.F.E	P.T.F.E	P.T.F.E	1
8	Gland	SS 316	SS 304	SS 304	1
9	Spring Washer	SS	SS	SS	1
10	Stoper Pin	SS 304	SS 304	SS 304	1
11	Handle	CS PLATED	CS PLATED	CS PLATED	1
12	Nut	SS	SS	SS	1
13	Sleeve	P.V.C	P.V.C	P.V.C	1

Part No	Inlet	Outlet	L \pm 0.2	D \pm 0.2	PORT	H	L1
BAX-2BVFF-2W	1/8" NPT(F)	1/8" NPT(F)	58.00	25.00	4.50	32.00	95.00
BAX-4BVFF-2W	1/4" NPT(F)	1/4" NPT(F)	58.00	30.00	6.40	40.00	96.00
BAX-6BVFF-2W	3/8" NPT (F)	3/8" NPT (F)	58.00	30.00	9.00	38.00	95.00
BAX-8BVFF-2W	1/2" NPT (F)	1/2" NPT (F)	68.00	35.00	10.40	45.00	110.00
BAX-12BVFF-2W	3/4" NPT(F)	3/4" NPT(F)	80.00	45.00	19.00	54.00	130.00
BAX-16BVFF-2W	1" NPT (F)	1" NPT (F)	84.00	53.00	25.00	60.00	150.00
BAX-20BVFF-2W	1 1/4" NPT (F)	1 1/4" NPT (F)	105.00	70.00	32.00	52.00	200.00
BAX-22BVFF-2W	1 1/2" NPT (F)	1 1/2" NPT (F)	115.00	80.00	38.00	75.00	200.00
BAX-24BVFF-2W	2" NPT(F)	2" NPT(F)	125.00	102.00	50.00	85.00	200.00

BAX-BVMF-2W-12

MALE x FEMALE

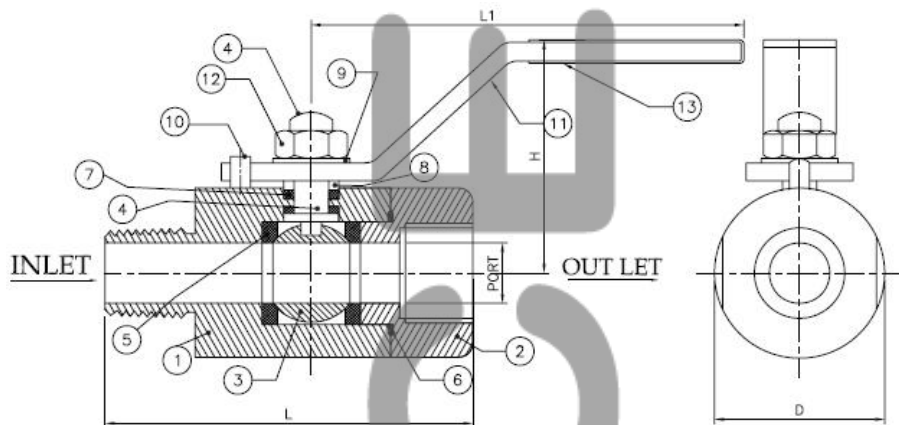

DIMENSIONAL DETAILS

Sr. No	Description	Material of Construction			Qty
1	Body	SS 316	SS 304	CS A 105	1
2	Adapter	SS 316	SS 304	CS A 105	1
3	Ball	SS 316	SS 304	SS 304	1
4	Spindle	SS 316	SS 304	SS 304	1
5	Ball Seat	P.T.F.E / CFT/GFT	P.T.F.E / CFT/GFT	P.T.F.E / CFT/GFT	2
6	Joint Seal	P.T.F.E	P.T.F.E	P.T.F.E	1
7	Gland Seal	P.T.F.E	P.T.F.E	P.T.F.E	1
8	Gland	SS 316	SS 304	SS 304	1
9	Spring Washer	SS	SS	SS	1
10	Stoper Pin	SS 304	SS 304	SS 304	1
11	Handle	CS PLATED	CS PLATED	CS PLATED	1
12	Nut	SS	SS	SS	1
13	Sleeve	P.V.C	P.V.C	P.V.C	1

Part No	Inlet	Outlet	L +/-4	D +/-2	PORT	H	L1
BAX-4BVMF-2W	1/4" NPT(M)	1/4" NPT(F)	78.00	30.00	6.00	35.00	100.00
BAX-8BVMF-2W	1/2" NPT(M)	1/2" NPT(F)	82.00	36.00	11.50	41.00	135.00

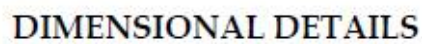

Part No	Inlet	Outlet	L +/-1	D +/-2	PORT	H	L1
BAX-4BVFM-2W	1/4" NPT(F)	1/4" NPT(M)	68.00	30.00	7.00	35.00	100.00



Baxcell Instrument Valves & Fittings Pvt. Ltd.

Office :

Unit No. : 129, Nidhi Industrial Complex,
Agarwal Chowk, Sativali , Vasai (East),
District – Palghar Pin Code : 401208
Maharashtra, India.

Tel : 0091-7722017801 / 02 / 03 / 04 / 05

Emails : sales@baxcell.com,
exports@baxcell.com,

Website: www.baxcell.com